

## WELL DRILLING HAMMERS

# WH5 TL QL50 3 1/2" API REG

Hammer 152 mm (6") - 203 mm (8") diameter holes

A highly dependable hammer with a simple but robust design

- Optimum performance at medium to high pressures ranging up to 35 bar (508 psi)
- Standard 3 1/2" API reg. pin backhead (available also with 2 3/8" API reg. pin backhead)
- QL50 bit shank fitting (available also with DHD350 bit shank fitting)

### Component parts

Ref	Description	Part number
1	Thread Protector API 3 1/2"	1099371
2	Backhead API 3 1/2"	604558
3a	Check Valve Plug Blank	604480
3b	Check Valve Plug 1/8"	604481
3c	Check Valve Plug 3/16"	604482
4	Check Valve	604444
5	Check Valve Spring	760079
6a	Shim - 4.5mm	604446
6b	Shim - 5.0mm	604447
6c	Shim - 5.5mm	604448
7	Compression Spring	760109
8	Air Feed Tube	604442
9	O-ring	768202
10	Inner Cylinder	605072
11	Retaining Ring	1107191
12	Wear Sleeve	605073
13	Piston	605071
14	Snap Ring	783054
15	Guide Bush	605074
16	O-ring	1098892
17	Bit Retainer QL50	604933
18	Chuck QL50	604934
19	End Cap	741020
	<b>Complete Hammer</b>	<b>1280584</b>

### Air consumption

PSI	BAR	m <sup>3</sup> /min	ft <sup>3</sup> /min
100	6.9	8.50	300
150	10.3	11.33	400
200	13.8	14.16	500
250	17.2	19.82	700
300	20.7	22.66	800
350	24.2	28.32	1000
400	27.6	31.15	1100
450	31.0	36.82	1300
500	34.5	39.65	1400

### Hammer specification

	Imperial	Metric
Weight (less bit)	132.3 lbs	60.0 kg
Length (less bit)	41.5"	1053 mm
Outside dia.	4.96"	126 mm

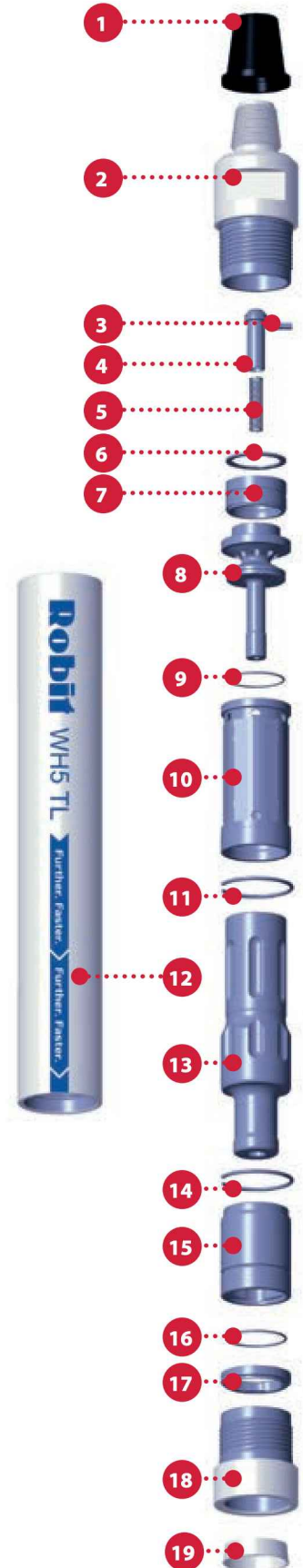

DTH Hammers